

# ETHOS

2025 GAS CLASS B MOTORHOME



2025 ENTEGRA COACH ETHOS

  
ENTEGRA  
COACH





# 2025 ETHOS

## Gas Class B Motorhome

20A

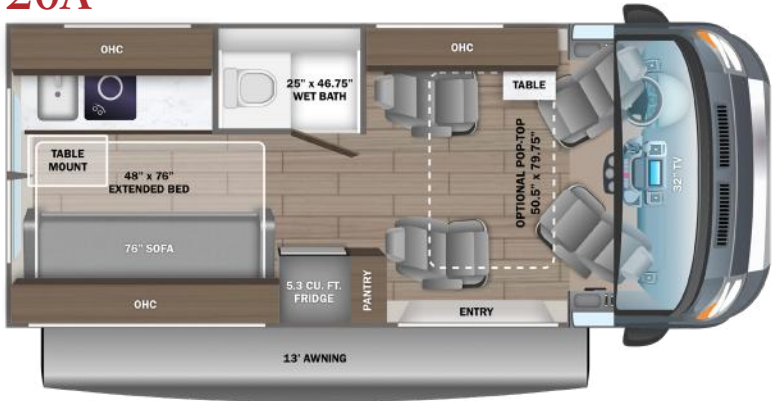

20E

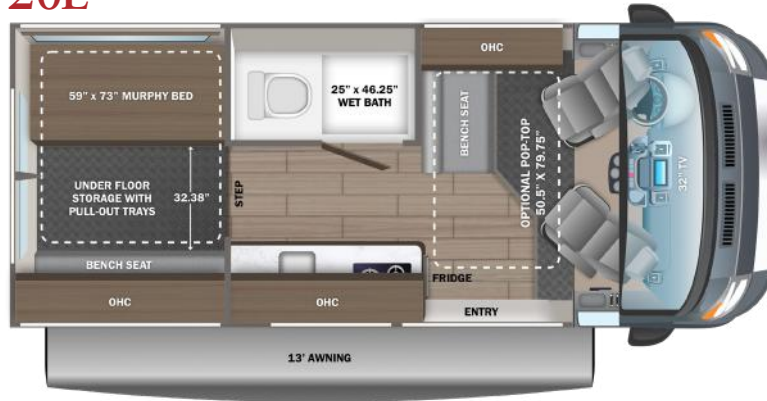

20T



20Y

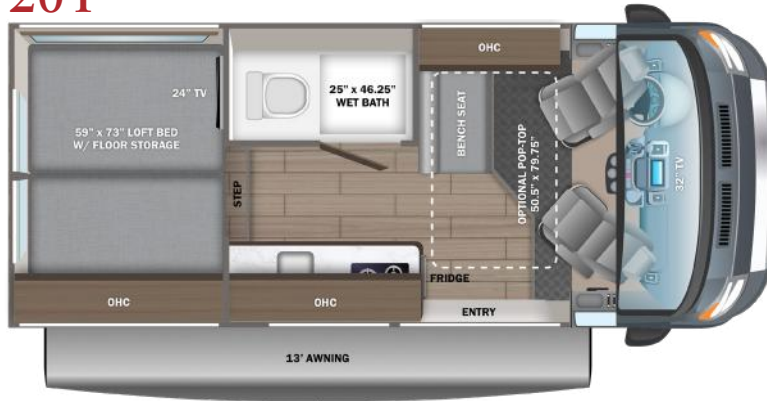

### EXTERIOR SELECTIONS



Silver Van



Granite Van

## CUSTOMER VALUE PACKAGE

E-Z Drive™: Hellwig helper springs, premium heavy-duty suspension  
 Thule® patio awning with LED light strip  
 Thule® roof rack (N/A with pop-top option)  
 Truma Combi Eco Plus water heater and furnace  
 Swivel driver and passenger seats with 6-way adjustment  
 Winegard® Connect 2.0 4G/Wi-Fi/digital TV antenna

## STANDARD CHASSIS EQUIPMENT

RAM® ProMaster 3500 window van  
 GVWR - 9,350 lb.  
 GCWR - 12,000 lb.  
 3.6L V6 24V VVT 276HP engine with 250 ft.-lb. torque  
 9-speed automatic 948TE transmission  
 LT225/75R 16E tires  
 Aluminum wheels  
 3,500 lb. rear hitch receiver with dual 4/7 pin connector  
 12V chassis battery  
 24 gal. fuel tank (gas)

## STANDARD EXTERIOR EQUIPMENT

LED-lit running boards for cab and entry doors  
 Chrome grille package  
 Cable TV hookup with RG-6 coax  
 Onan® 2,800W generator with auto-gen start  
 200W roof-mounted GoPower® solar panel with integrated control panel  
 1,000W inverter  
 (2) 12V AGM house batteries  
 House battery disconnect switch  
 30-amp electrical service with detachable power cord  
 (2) 120V exterior outlets  
 6 gal. propane tank (20 lb.)  
 LP quick-connect hookup  
 Heated holding tanks (12V pads)  
 LED-lit holding tank valves  
 Black tank flush  
 Gravity water fill (20T)  
 Winterization drain system  
 12V demand water pump  
 Water filtration system  
 Outside shower

## STANDARD COCKPIT EQUIPMENT

Uconnect® 5 NAV infotainment center with Apple CarPlay™ and Android Auto™  
 Power folding/heated side-view mirrors

Push-button start  
 ParkView® rear backup camera with dynamic gridlines  
 Blind spot monitoring with rear cross path detection  
 LaneSense® lane departure warning with lane keep assist  
 Forward collision warning with active braking  
 Crosswind assist  
 Electronic stability control  
 Pedestrian/cyclist emergency braking  
 Traffic sign information  
 Drowsy driver detection  
 Rain-sensitive windshield wipers  
 Automatic high-beam headlights  
 Cruise control  
 Driver and passenger airbags  
 Wireless charging pad  
 Power windows and door locks  
 Privacy shades for cab windows  
 Remote keyless entry

## STANDARD INTERIOR EQUIPMENT

Custom-molded ABS interior wall panels  
 Soft-touch vinyl ceiling  
 High-intensity LED ceiling lights  
 Tecnoform® European-style, high-gloss cabinetry  
 Ball-bearing drawer guides  
 Residential vinyl flooring  
 Firefly Multiplex system - wall-mounted touchscreen and mobile app for total coach control  
 120V Coleman®-Mach® 10 13,500 BTU air conditioner  
 Powered roof vent in living area  
 Zip-up screen for entrance door  
 Removable privacy shade for sliding door window  
 Sliding vented windows  
 Decorative window valances with day/night roller shades  
 Zip-up screen for rear doors (20A)  
 Rear magnetic privacy shades  
 Adjustable table with multiple mounts  
 (2) cab bucket seats (20A)  
 Seatbelts for driver/passenger seats and select cab locations  
 32 in. front TV on drop-down bracket (20A, 20E, 20Y)  
 24 in. rear TV on swivel bracket (20T, 20Y)  
 JBL® Flip 6 removable wireless Bluetooth speaker  
 Smoke alarm  
 Carbon monoxide detector  
 Fire extinguisher  
 5.3 cu.ft. DC refrigerator (20A)  
 3.1 cu.ft. DC refrigerator (20T)  
 3 cu.ft. DC refrigerator (20E, 20Y)  
 Convection microwave  
 2-burner gas cooktop (1-burner induction with pop-top option)  
 Stainless-steel sink with cover

Solid-surface kitchen countertop  
 Pop-up 120V/USB outlet in kitchen  
 (2) twin-size beds with filler cushion converts to king-size bed (20T)  
 Under-bed storage (20T)  
 48 in. x 76 in. convertible sofa bed (20A)  
 59 in. x 73 in. Murphy bed (20E)  
 59 in. x 73 in. loft bed with floor storage (20Y)  
 Under floor storage with pull-out trays (20E)  
 Bathroom wardrobe with drawers (20T)  
 Shower with magnetic curtain surround  
 Aqua View® SHOWERMISER™ water management system  
 Toilet with foot flush  
 Medicine cabinet with mirror  
 Powered roof vent in bathroom (N/A with pop-top option)

## OPTIONS

50.5 in. x 79.5 in. pop-top (20A, 20E, 20Y)  
 (2) additional cab seats with slide and recline features ILO bench seat (20E, 20Y)  
 Workstation ILO bench seat (20E, 20Y)

## Li Package

- 48V-165 amp hour smart lithium battery providing 7.9KW hours of power  
 IPO 2,800W generator and (2) 12V AGM house batteries  
 - Auto engine start with high idle  
 - 3,000W inverter IPO 1,000W inverter  
 - 2nd 48V alternator dedicated to lithium battery  
 - Timberline hydronic heating system IPO Truma Combi Eco Plus water heater and furnace  
 - 48V Coleman®-Mach® 10 13.5K BTU air conditioner IPO 120V Coleman®-Mach® 10 13.5K BTU air conditioner  
 - 1-burner induction cooktop IPO 2-burner gas cooktop  
 - No propane - all-electric coach



At Entegra Coach, we build our RVs to handle every adventure, then back them with an outstanding warranty. Our 2-year limited warranty has you covered for 2 camping seasons. That's 730 days. For a copy of our 2-year limited warranty with complete terms and conditions, please contact your local Entegra Coach dealer.

Floorplan	GVWR (lbs.)	GCWR (lbs.)	Wheel Base	Overall Length	Exterior Height w/ A/C & Satellite	Exterior Width	Interior Height	Fresh Water Capacity (gal.)	Grey Waste Water Capacity (gal.)	Black Waste Water Capacity (gal.)
20A	9,350	12,000	159	20' 11"	9' 3"	83	74	21	13/14	10
20E	9,350	12,000	159	20' 11"	9' 3"	83	74	21	20	10
20T	9,350	12,000	159	20' 11"	9' 3"	83	74	24	13	12
20Y	9,350	12,000	159	20' 11"	9' 3"	83	74	21	20	10

It is important for your safety and enjoyment that you are aware of the weights and tow ratings of the RV you select. Consult a competent advisor for questions or advice. Whether you are new to RVing or a veteran, get a feel for the performance of your RV before heading out on the roadways. When you tow a vehicle with your RV, you must drive differently than when you drive a single vehicle. Practice hooking up, driving, backing up and braking in a safe environment or seek out professional instruction. Jayco affixes a weight label to each RV which lists weight information for that vehicle. Refer to that label to verify the vehicle will meet your requirements. Gross Vehicle Weight Rating (GVWR): The maximum permissible weight of the motorhome, including the Unloaded Vehicle Weight (UVW) plus passengers, personal items, all cargo, fluids, options and dealer-installed accessories. The GVWR is equal to or greater than the sum of the UVW and the Cargo Carrying Capacity. Gross Combined Weight Rating (GCWR): The maximum allowable combined weight of the motorhome used as a tow vehicle and the attached towed vehicle.



LaMesaRV.com  
 800-496-8778



Part of Jayco Family of Companies

Entegra Coach, Inc., P.O. Box 460, Middlebury, IN 46540, www.entegracoach.com. See dealer for further information and prices. All information in this brochure is the latest available at the time of publication approval. Entegra Coach reserves the right to make changes and to discontinue models without notice or obligation. Photos in this brochure may show optional equipment and props for photography purposes. RVs built for sale in Canada may differ to conform to Canadian codes. ©2025 Entegra Coach, Inc. Printed in U.S.A. 2032933



entegracoach.com/ethos

LEGACY ISN'T LEFT,  
 IT'S LIVED.